

MARK YOUR CALENDAR

NEWARK TRACKING & TRAINING ASSOCIATES
FORT ERIE, ONTARIO

PRESENTS
FOUR ALL BREED - LIMITED ENTRY
CANADIAN KENNEL CLUB
LICENSED

AGILITY TRIALS

(OUR 49, 50, 51 & 52 CKC AGILITY TRIALS)

10 MINUTES FROM THE PEACE BRIDGE - BUFFALO, N.Y.

SAT. AUG. 12 & SUN. AUG. 13, 2006

1 STANDARD CLASS AND 2 JWW CLASS EACH DAY (NEW)

REGULAR CLASSES
NOVICE "A" & "B", INTERMEDIATE, EXCELLENT "A" & "B"
SELECTED CLASSES

NOVICE, INTERMEDIATE AND EXCELLENT "A" & "B" (NEW)

HELD AT
COMPETITOR DOG TRAINING
3066 BOWEN ROAD,
FORT ERIE, ONTARIO

THIS EVENT HELD UNDER THE RULES OF THE CANADIAN KENNEL CLUB

OUTDOORS - ON GRASS - RING SIZE 100 X 110
NO COVER PROVIDED IN CASE OF INCLEMENT WEATHER

ENTRIES OPEN - 9:00 AM MAY 20TH, 2006

ENTRIES CLOSE - TUESDAY MIDNIGHT AUG. 1ST, 2006

OR AUTOMATICALLY WHEN THE LIMIT OF 99 DOGS PER TRIAL IS REACHED

To comply with instructions issued by the CKC we will be unable to accept, cancel, alter, or substitute any entry reaching our Trial Secretary after the above time and date and or when the limit per trial has been reached.

THE PENINSULA INN & RESORT, NIAGARA FALLS - 905-354-8812
(ABOUT 20 MINUTES AWAY, EXTRA CHARGE FOR DOGS.)

BEST WESTERN FALLSVIEW, NIAGARA FALLS - 905-356-0551
(ABOUT 25 MINUTES AWAY, www.bestwesternfallsview.com)

CAMPING

KNIGHTS HIDE AWAY CAMPING AND TRAILER PARK - 905-894-1911
(ABOUT 5 MINUTES AWAY)

OFFICIAL PREMIUM LIST

NEWARK TRACKING & TRAINING ASSOCIATES
FORT ERIE, ONTARIO

PRESENTS
FOUR ALL BREED - LIMITED ENTRY
CANADIAN KENNEL CLUB
LICENSED

AGILITY TRIALS

(OUR 45, 46, 47 & 48 CKC AGILITY TRIALS)

10 MINUTES FROM THE PEACE BRIDGE - BUFFALO, N.Y.

SATURDAY JUNE 3 & SUNDAY JUNE 4, 2006

1 STANDARD CLASS AND 2 JWW CLASS EACH DAY (NEW)

REGULAR CLASSES
NOVICE "A" & "B", INTERMEDIATE, EXCELLENT "A" & "B"
SELECTED CLASSES

NOVICE, INTERMEDIATE AND EXCELLENT "A" & "B" (NEW)

HELD AT
COMPETITOR DOG TRAINING
3066 BOWEN ROAD,
FORT ERIE, ONTARIO

THIS EVENT HELD UNDER THE RULES OF THE CANADIAN KENNEL CLUB

OUTDOORS - ON GRASS - RING SIZE 100 X 110
NO COVER PROVIDED IN CASE OF INCLEMENT WEATHER

ENTRIES OPEN - NOW OPEN

ENTRIES CLOSE - TUESDAY, MIDNIGHT, MAY 23

OR

AUTOMATICALLY WHEN THE LIMIT OF 75 DOGS PER TRIAL HAS BEEN REACHED

To comply with instructions issued by the CKC we will be unable to accept, cancel, alter, or substitute any entry reaching our Trial Secretary after the above time and date and or when the limit per trial has been reached.

UNDER C.K.C RULES THERE SHALL BE NO SMOKING WITHIN THE COURSE AREA AT ANY TIME

OFFICERS

PRESIDENT JERRY BURKE
VICE PRESIDENT MARILYN BENNER
SECRETARY/ TREASURER IKENA HILMAYER

AGILITY TRIAL COMMITTEE

TRIAL CHAIRWOMAN IKENA HILMAYER
TRIAL SECRETARY JERRY BURKE
ASSISTANT TRIAL SECRETARY SUE GURNEY
COMMITTEE MEMBERS SUE GUENTHER
MARILYN BENNER

VETERINARIAN FORT ERIE ANIMAL HOSPITAL
35 WALDEN BLVD, FORT ERIE (905) 871 1653

TRIAL SECRETARY JERRY BURKE
3066 BOWEN ROAD,
STEVENSVILLE, ONT L0S 1S0
905-382-3087 Or EMAIL jburke@vaxxline.com

ASSISTANT TRIAL SECRETARY SUE GURNEY
ONTARIO CENTRAL DIRECTOR
JOE MAURO - acting CEO Alan Pepper

100-89 Skyway Ave.,
Etobicoke, Ont. M9W 6R4 CKC AGILITY REPRESENTATIVE - SUSAN BITA

Eligibility: To be eligible to compete in this trial a dog must be at least 18 months of age and registered with the CKC or eligible for registration with the CKC, have a PEN, and ERN or have a CKC Miscellaneous Certificate number. Bitches in season are not permitted to compete in the trial however, entry and listing fees will be returned, providing a veterinarian's certificate stating that the bitch was in season within the 10 day period proceeding the trial is submitted to the Trial Secretary on or before the day of the trial.

JUDGES AND ASSIGNMENTS

SATURDAY - JUNE 3RD 2006 TRIAL 45 & 46 - ALL CLASSES

PAMELA STURITZ
458 BLAKESLEY-NURSE HOLLOW RD.,
AFTON, N.Y. 13730-9716

SUNDAY - JUNE 4TH 2006

TRIAL 47 & 48 - ALL CLASSES
PAULINE KARALTA
808 FARMINGTON RD.,
MACEDON, N.Y. 14502-9721

IT IS THE DUTY AND OBLIGATION OF THE TRIAL-GIVING CLUB TO SEE THAT A JUDGE, CLUB OFFICIAL, VOLUNTEER OR ANY PARTICIPANT AT THE EVENT HELD UNDER THESE RULES, IS NOT SUBJECT TO INDIGNITIES OF ANY KIND. THE AGILITY TRIAL COMMITTEE CHAIR SHALL PROMPTLY REPORT TO THE CKC ANY INFINGEMENT OF THIS REGULATION, AND THE DISCIPLINE COMMITTEE SHALL "IT IS THE DUTY AND OBLIGATION OF THE TRIAL-GIVING CLUB TO SEE THAT A HAVE THE AUTHORITY TO TAKE WHATEVER ACTION AS IT DEEMS FIT, ON RECEIPT OF A REPORT INDICATING THAT THIS HAS OCCURRED

WE ASKED THAT YOU KEEP THE GROUNDS CLEAN, PLEASE PICK UP AFTER YOU AND YOUR DOG AT THE TRIAL SITE AND MOTEL. ANY COMPETITOR OR SPECTATOR NOT DOING SO WILL BE ASKED TO LEAVE THE PREMISES.

POOP RAFFLES WILL BE HELD THROUGHOUT THE DAY AND A RAFFLE TICKET WILL BE GIVEN FOR EACH "BAG" DEPOSITED IN THE GARGAGE.

IT IS THE RESPONSIBILITY OF THE EXHIBITOR TO HAVE THE DOG AT RINGSIDE WHEN THE DOG'S CLASS IS SCHEDULED FOR JUDGING. IF A DOG IS NOT AT RINGSIDE AFTER IT HAS BEEN CALLED THREE TIMES IT WILL BE MARKED ABSENT.

THE NEWARK TRACKING & TRAINING ASSOCIATES WILL USE DUE CARE AND DILIGENCE FOR THE WELFARE OF DOGS AND EXHIBITORS BUT WILL NOT BE RESPONSIBLE FOR, OR ASSUME LIABILITY IN THE EVENT OF ACCIDENT OR OTHER MISFORTUNES, TO EITHER DOGS, EXHIBITORS OR PATRONS.

MOTELS

COMFORT INN, 1 HOSPITALITY DR. FORT ERIE
905-871-8500

CAMPING

KNIGHTS HIDE AWAY CAMPING & TRAILER PARK.

COMPETITOR DOG TRAINING

3066 BOWEN ROAD, STEVENSVILLE, ONT.
905-382-3087

JERRY BURKE & IKENA HILMAYER
jburke@vaxxline.com or ikena@vaxxline.com

- TRACKING CLASSES -- COMPETITION OBEDIENCE
- AGILITY CLASSES - RALLY CLASSES
- PRIVATE LESSONS - PROBLEM SOLVING
- AGILITY AND OBEDIENCE EQUIPMENT
- SCENT ARTICLES AND MUCH MORE

COMPETITOR DOG TRAINING WEBSITE

<http://sitecreator.com/CompetitorDogTraining>

NEWARK TRACKING AND TRAINING WEBSITE

<http://sitecreator.com/Newark>

FOOD WILL BE AVAILABLE AT THE TRIAL SITE

VOLUNTEER TO WORK - WORKERS RECEIVE FREE LUNCH AND TICKETS TO A WORKERS RAFFLE

VOLUNTEER TO WORK

I AM ABLE TO HELP: SAT. 1ST TRIAL () 2ND TRIAL ()
SUN. 1ST TRIAL () 2ND TRIAL ()

I AM ENTERED IN _____ CLASSES

ICAN DO THE FOLLOWING: SCORE TABLE, SCRIBE, TIMER, STEWARD,
GATE STEWARD, SCORE RUNNER, LEASH RUNNER, COURSE BUILDER.

WORKERS RAFFLES WILL BE HELD EACH DAY AND AN ADDITIONAL DRAW
WILL BE HELD FOR COURSE BUILDERS.

**** ALL WORKERS WILL RECEIVE A FREE LUNCH ****

FROM PEACE BRIDGE/BUFFALO AREA, TAKE THE QUEEN ELIZABETH HIGHWAY TOWARD
NIAGARA FALLS, ST. CATHARINES AND TORONTO. EXIT BEFORE BOWEN IS GILMORE.
EXIT ON BOWEN, TURN LEFT ON BOWEN (BOWEN ROAD WEST) AND GO EXACTLY TWO
MILES. TRIAL SITE IS ON THE RIGHT HAND SIDE OF THE ROAD, TWO STORY BLUE
GREY HOUSE. 3066 BOWEN.

FROM NIAGARA FALLS, ST. CATHARINES AND TORONTO, TAKE THE QUEEN ELIZABETH
HIGHWAY TOWARD FORT ERIE AND BUFFALO. EXIT BEFORE BOWEN IS NETHERBY.
EXIT ON BOWEN, TURN RIGHT (BOWEN ROAD WEST) AND GO EXACTLY TWO MILES.
TRIAL SITE IS ON THE RIGHT HAND SIDE OF THE ROAD, TWO STORY BLUE GREY
HOUSE, 3066 BOWEN

SCENT ARTICLES

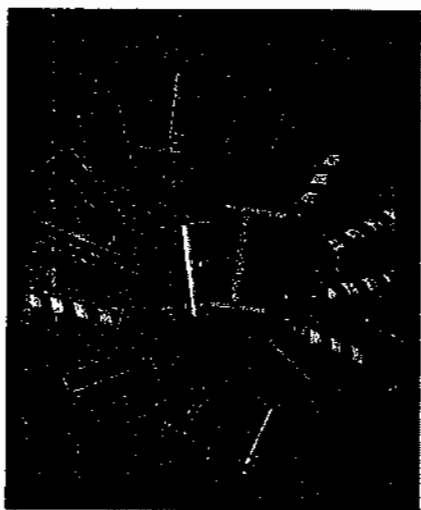

Scent Articles FOR SALE

6 wood
6 leather
6 metal

UNIQUE SETS OF
HAND MADE
SCENT ARTICLES

email: ikena@vaxxine.com OR jburke@vaxxine.com

CLASSES OFFERED

Regular Standard and Jumper with Weaves

Selected Standard and Selected Jumpers with Weaves
DOG RUNNING IN SELECTED MUST BEGIN AT THE NOVICE LEVEL.

DOGS MAY MOVE BETWEEN REGULAR AND SELECTED CLASSES, BUT NOT AT THE
SAME SET OF TRIALS.

TITLES EARNED IN REGULAR CLASSES AND SELECTED CLASSES ARE RECORDED
AND ARE SEPARATE TITLES.

SELECTED CLASSES ARE DIVIDED INTO NOVICE, INTERMEDIATE, EXCELLENT A & B
NOVICE "A" CLASS IS FOR PERSONS AND DOGS THAT HAVE NEVER ACQUIRED
AN AGILITY TITLE IN ANY COUNTRY OR WITH ANY ORGANIZATION.

NOVICE "B" IS FOR DOGS HANDLED BY AGILITY INSTRUCTORS AND JUDGES,
AND FOR DOGS THAT HAVE OR HAVE NOT ACQUIRED THE AGILITY NOVICE TITLE,
BUT HAVE NOT EARNED A QUALIFYING SCORE IN AGILITY INTERMEDIATE AND IS
FOR DOGS HANDLED BY PERSONS WHO HAVE PREVIOUSLY EXHIBITED A DOG TO
AN AGILITY TITLE IN ANY ORGANIZATION.

THE REGULAR AND SELECTED STANDARD AND JWW INTERMEDIATE CLASS
IS OPEN TO DOGS THAT HAVE ACQUIRED THE AGILITY INTERMEDIATE TITLE, BUT
HAVE NOT YET ACQUIRED A QUALIFYING SCORE TOWARDS THE AGILITY
EXCELLENT TITLE.

THE REGULAR AND SELECTED STANDARD AND JWW EXCELLENT "A" CLASS
IS FOR DOGS THAT HAVE ACQUIRED THE AGILITY INTERMEDIATE TITLE, BUT HAVE
NOT YET EARNED THE AGILITY EXCELLENT TITLE.

THE REGULAR AND SELECTED STANDARD AND JWW EXCELLENT "B" CLASS
IS FOR DOGS THAT HAVE ACQUIRED THE AGILITY EXCELLENT TITLE OR THE
AGILITY MASTER EXCELLENT TITLE.

HEIGHT DIVISIONS - STANDARD

8" FOR DOGS 10" AND UNDER
12" FOR DOGS 14 INCHES AND UNDER
16" FOR DOGS 18 INCHES AND UNDER
20" FOR DOGS 22 INCHES AND UNDER
24" FOR DOGS 24 INCHES AND UNDER

HEIGHT DIVISIONS -- SELECTED
SELECTED CLASS DOGS WILL JUMP
ONE HEIGHT LOWER THAN THE
EQUIVALENT REGULAR CLASS HEIGHT
8" DOGS WILL JUMP 4"

HANDLERS ARE RESPONSIBLE FOR ENTERING THE CORRECT HEIGHT DIVISION.

THE JUDGE MAY REQUEST ANY DOG BE MEASURED.

THERE WILL BE **NO** EQUIPMENT FAMILIARIZATION ON THE DAY OF THE TRIAL. A
WARM UP-AREA AND SINGLE PRACTICE JUMP WILL BE PROVIDED FOR DOGS
ENTERED IN THE TRIAL.

MOVE-UP-OPTION DOGS MAY MOVE UP TO THE NEXT CLASS BETWEEN DAYS OF
THE TRIAL (i.e. from Saturday to Sunday) BY FILLING IN THE REQUIRED MOVE-UP
FORM.



OFFICIAL CANADIAN KENNEL CLUB FORM—AGILITY
Newark Tracking & Training Assoc.
3066 Bowen Road, Stevensville, Ont. L0S 1S0

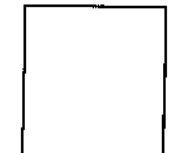

AWARDS AND PRIZES
 ROSETTES WILL BE OFFERED FOR ALL FIRST PLACES IN EACH JUMP HEIGHT IN EACH CLASS AND FLAT RIBBONS WILL BE AWARDED FOR 2nd, 3rd AND 4th PLACES AS WELL AS QUALIFYING SCORES.

TITLE COMPLETION ROSETTES WILL ALSO BE AWARDED FOR ANY NEW TITLE EARNED AT THIS TRIAL.

ENTRY AND LISTING FEES

ENTRY FEE PER DOG/PER RUN: \$20.00 CAN. FUNDS OR \$18.00 U.S. FUNDS.

PACKAGE DEAL: SIX RUNS/SAME DOG \$100.00 CAN. OR \$90.00 US.

LISTING FEE PER DOG/PER TRIAL (REQUIRED IF NO CKC/ERN OR MISC. CERT. #) \$5.35 CAN. OR \$4.50 US. PER DOG PER TRIAL.

ALL FEES INCLUDE THE 7% GST

**ALL FEES PAYABLE TO: NEWARK TRACKING & TRAINING ASSOCIATES
 1 MAIL ENTRIES AND FEES TO:**

JERRY BURKE, 3066 BOWEN ROAD, STEVENSVILLE, ONT. L0S 1S0

OR IN THE U.S.:

SUE GURNEY, 14 BLUE RIDGE COURT, GETZVILLE, N.Y. 14068

ATTENTION U.S. EXHIBITORS: WE WILL ACCEPT U.S. CHECKS AS NOTED IN THE ENTRY FEES. DUE TO THE CONSTANTLY FLUCTUATING CURRENCY RATES, DISCOUNTED CHECKS ARE NOT ACCEPTED. PERSONAL CHECKS WILL BE ACCEPTED; HOWEVER, THEY MUST BE MADE PAYABLE IN U.S. FUNDS IN THE AMOUNT NOTED UNDER ENTRY FEES.

EXHIBITORS, THROUGH SUBMISSION OF ENTRY, ACKNOWLEDGE THAT THEY ARE KNOWLEDGEABLE OF AND WILL COMPLY WITH THE C.K.C. AGILITY RULES AND REGULATIONS, EFFECTIVE JANUARY 2006.

ALL PARTICULARS CALLED FOR ON THE ENTRY FORM MUST BE COMPLETE. ANY TELEPHONE CALLS REQUIRED TO CONFIRM INFORMATION WILL BE MADE COLLECT. EXHIBITORS MUST ABIDE BY ERRORS MADE IN ENTERING THEIR DOG/S REGARDLESS OF HOW OR BY WHOM THE ENTRIES WERE MADE. NO ENTRY WILL BE ACCEPTED UNLESS ACCOMPANIED BY THE FULL ENTRY FEE. NTA RESERVES THE RIGHT TO REFUSE ANY ENTRY SUBJECT TO C.K.C. RULES. IF BECAUSE OF RIOTS, CIVIL DISTURBANCES OR ACTS BEYOND THE CONTROL OF NTA AND THE TRIAL COMMITTEE, IT IS IMPOSSIBLE TO OPEN OR COMPLETE THE TRIAL, NO REFUND OF ENTRY FEES WILL BE MADE. ALL ENTRY CONFIRMATION AND JUDGING SCHEDULES WILL BE MAILED OR E-MAILED AS SOON AS POSSIBLE AFTER ENTRIES CLOSE.

ALL DOGS ARE TO BE KEPT ON LEASH AND UNDER CONTROL EXCEPT WHEN REQUIRED TO BE OFF LEASH FOR RUNNING THE COURSE.

**June 3 - Trial #45 STD () JWW ()
 Trail #46 JWW ()
 June 4 - Trial #47 STD () JWW ()
 Trial #48 JWW ()**

Entry Fee \$ _____ Listing Fees _____ Total Fee Enclosed \$ _____

Breed _____ Variety _____ Sex _____

AGILITY TRIAL CLASS (Check one)

STD. Class - Regular Nov. A Nov. B Intermed. ExA ExB - Selected Nov. Intermed. ExA ExB

JWW Class - Regular Nov. A Nov. B Intermed. ExA ExB - Selected Nov. Intermed. ExA ExB

JUMP HEIGHT DIVISION (Turdle Dne)

4" 8" 12" 16" 20" 24"

Height at Withers _____

Registered Name of Dog _____

(Call Name)

Check One and Enter Number here

CKC Reg. No.

CKC ERN No.

CKC Misc. Cert. No.

Listed

P.E.N. NO. Listed (fee \$8.00)

Breeder(s) _____

Place of Birth Canada Elsewhere

Sex _____

Size _____

Don _____

Reg'd. Owner(s) _____

Owner's Address _____

City _____

Postal Code _____

Home of Owner's Agent (if any) at the Show _____

Agent's Address _____

City _____

Postal Code _____

Handler _____

E-Mail: Mail ID to: Owner Agent

(EXIT) that I am the registered owner(s) of the above dog or that I am the authorized agent of the owner(s) whose name(s) have entered above and accept full responsibility for all statements made in this entry. In consideration of the acceptance of this entry, I/we agree to be bound by the rules and regulations of the Canadian Kennel Club and by any additional rules and regulations appearing in the program list.

Signature of Owner or Agent _____

E-Mail Address (if available) _____

Telephone Number _____

VOLUNTEER TO WORK

I AM ABLE TO HELP: SAT. 1ST TRIAL () 2ND TRIAL ()
 SUN. 1ST TRIAL () 2ND TRIAL ()

I AM ENTERED IN: _____

I CAN DO THE FOLLOWING: STEWARD, SCRIBE,

COURSE BUILDER, GATE STEWARD, SCORE RUNNER,

LEASH RUNNER, SCORE TABLE, TIMER

**WORKERS RAFFLES WILL BE HELD EACH AND AN
 ADDITIONAL DRAW WILL BE HELD FOR COURSE BUILDERS.**

ALL WORKERS WILL RECEIVE A FREE LUNCH.



OFFICIAL CANADIAN KENNEL CLUB FORM—AGILITY
Newark Tracking & Training Assoc.
 3066 Bowen Road, Stevensville,
 Ont. L0S 1S0

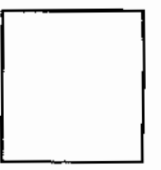

June 3 - Trial #45 STD () JWW ()
 Trail #46 JWW ()
 June 4 - Trial #47 STD () JWW ()
 Trial #48 JWW ()

Breed _____ Variety _____ Sex _____

AGILITY TRIAL CLASS (Check and Circle one)

STD, Class - Regular Nov. A Nov. B Intermed. ExA ExB - Selected Nov. Intermed. ExA ExB

JWW Class - Regular Nov. A Nov. B Intermed. ExA ExB - Selected Nov. Intermed. ExA ExB

JUMP HEIGHT DIVISION (Circle One)

4" 8" 12" 16" 20" 24"

Height of Withers _____

Registered Name of Dog _____

Call Home _____

Check One and Enter Number here
 CKC Reg. No. _____
 CKC ERN No. _____
 CKC Misc. Cert. No. _____
 Listed _____
 P.E.N. NO. _____ Listed (fee: \$8,000) _____

Date of Birth
 D _____ M _____ YYYY _____

Place of Birth Canada Elsewhere

Breeder(s) _____

Sire _____

Dam _____

Reg'd. Owner(s) _____

Owner's Address _____

City _____ Prov. _____ Postal Code _____

Name of Owner's Agent (if any) of the Show _____

Agent's Address _____

City _____ Prov. _____ Postal Code _____

Handler _____

E-Mail / Mail ID to: Owner Agent
 I CERTIFY that I am the registered owner(s) of the above dog or that I am the authorized agent of the owner(s) whose name(s) I have entered above and accept full responsibility for all statements made in this entry. All considerations of the acceptance of this entry, I (we) agree to be bound by the rules and regulations of the Canadian Kennel Club and by any additional rules and regulations appearing in the premium list.

Signature of Owner or Agent _____

E-Mail Address (if applicable) _____

Telephone Number _____